

Fusion

Product Specifications

ITEM NO: _____
PROJECT: _____
DATE: _____

Inline Refrigerated Service Case



MODEL SHOWN: FB4S-3R

- ☐ FB3S-2R
- ☐ FB4S-3R
- ☐ FB5S-4R
- ☐ FB6S-5R

Lengths include end panels
37"L x 43"D x 51-3/4"H
50"L x 43"D x 51-3/4"H
63"L x 43"D x 51-3/4"H
76"L x 43"D x 51-3/4"H

STANDARD FEATURES

- Remote w/thermostat, solenoid & TXV
- 15-5/8" Toe kick
- Blue Fin coated coil
- Condiment pan support rails
- Electrical leads
- Integrated average product temperature of 40°F or less
- NOTE: Pans not supplied with case.
- NOTE: Remote only available w/rail base w/shims. N/A w/levelers, casters or legs.
- One year parts & labor warranty
- Rail system for shims
- Rear wrapping board, white Sanalite®
- Stainless steel interior

Features	Standard	Options
EXTERIOR COLOR	<input type="checkbox"/> Laminated (non-premium) Confirm pattern/grain direction	<input type="checkbox"/> Laminated (premium) Confirm pattern/grain direction <input type="checkbox"/> Stainless steel
COUNTER	<input type="checkbox"/> Stainless steel	<input type="checkbox"/> 3 cm. Quartz
REAR STORAGE	<input type="checkbox"/> Non-refrigerated rear storage (w/o doors)	<input type="checkbox"/> Non-refrigerated rear storage w/ sliding doors <input type="checkbox"/> Refrigerated rear storage w/ sliding doors
TOE KICK	<input type="checkbox"/> Painted - Black	<input type="checkbox"/> Stainless steel
SNEEZE GUARD	<input type="checkbox"/> Clear sneeze guard glass w/ stainless steel posts	<input type="checkbox"/> UV bonded frameless glass (3" glass gaps case-to-case)
REFRIGERATION	<input type="checkbox"/> Remote w/thermostat, solenoid & TXV	<input type="checkbox"/> Note: Remote doesn't incl Conds unit. Floor drain reqd.
MISCELLANEOUS		<input type="checkbox"/> Second year parts & labor warranty

Fusion

Product Specifications

Intended Environment: Type I - Designed to operate in ambient conditions of 75°F with 55% relative humidity unless noted otherwise in system information below.

Zone	Intended Product To Be Displayed	Warmest Avg Prod Temp ° F
1	Unpackaged refrigerated products	40

PLAN VIEW

SIDE VIEW

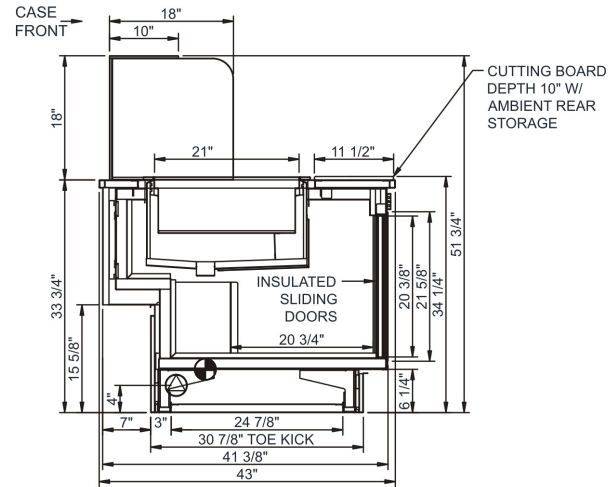
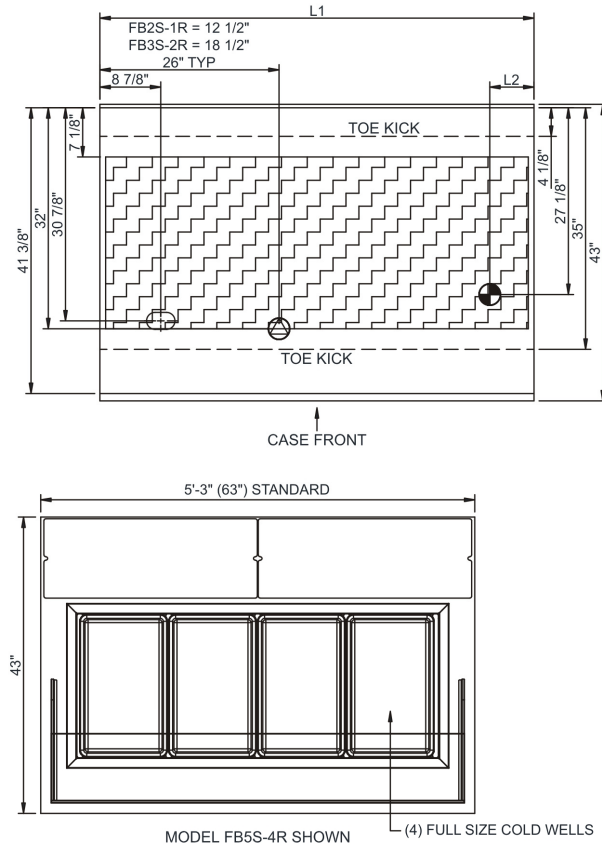

NOTE: ALL DIMENSIONS APPROXIMATE

- ELECTRICAL JUNCTION BOX (SUPPLIED WITH 6\" LEADS OR POWER CORD).
- REMOTE FLOOR SINK & UTILITIES ACCESS AREA.
- LOCATION OF DRAIN TUBE FOR REMOTE REF. ONLY (SUPPLIED WITH 3/4\" OR 1 1/2\" PVC TUBE).
- SELF-CONTAINED CASE SERVICE ACCESS AREA.
- REFRIGERATION LINE CONNECTION.
- DRY CASE SERVICE ACCESS AREA.

Model Technical Specifications

Model	L"	L1"	L2"	System Circuit Volts			Phs	Freq	Amps ***	Watts	Wires	NEMA Plug	SST	Conv. Rack BTUH	Para. Rack BTUH	Est Wt
FB3S-2R	N/A	37.00	6.38	Remote(Type I)	Circuit #1	110-120	1	60	1.06	104	2+G	Leads Multiple	20.00	1123	1040	600
FB4S-3R	N/A	50.00	6.38	Remote(Type I)	Circuit #1	110-120	1	60	1.17	117	2+G	Leads Multiple	20.00	1296	1200	750
FB5S-4R	N/A	63.00	6.38	Remote(Type I)	Circuit #1	110-120	1	60	1.27	128	2+G	Leads Multiple	20.00	1469	1360	900
FB6S-5R	N/A	76.00	6.38	Remote(Type I)	Circuit #1	110-120	1	60	1.36	140	2+G	Leads Multiple	20.00	1642	1520	1,100

*** Does not include electric defrost on freezer models.

Important Notes:

⚠ WARNING: This product can expose you to chemicals, including Urethane (Ethyl Carbamate), which are known to the State of California to cause cancer and birth defects or other reproductive harm. For more information go to www.P65Warnings.ca.gov.

Regulatory Approvals:

All Models
 Accordance with AHRI Std 1200
 ETL Listed to UL 471
 ETL Listed to CAN/CSA 22.2 No. 120
 ETL Sanitation to NSF 7



In Accordance with
AHRI Std 1200

DOE 2017
 Energy Efficiency
 Compliant

888 E. Porter Rd.
 Muskegon, MI 49441
 Ph. 231-798-8888
 Fx. 231-798-4960
www.structuralconcepts.com

Note: Information is subject to change at any time.
 Visit www.structuralconcepts.com for the most current specs.

Revised 7/30/2019

21413605

