



# BEVERAGE-AIR

Project: _____	AIA# _____
Item: _____	
Location: _____	SIS# _____
Approved: _____	

## MMR MARKETMAX REFRIGERATOR

MMR72HC White Hinged Triple Glass Door  
Hydrocarbon Series

**MODELS:**  
**MMR72HC-1-W**



**MMR72HC-1-W**

### OPTIONS & ACCESSORIES

- ☐ White or stainless steel exterior option
- ☐ Black or stainless steel interior option
- ☐ Wine models available
- ☐ Wine thermometer
- ☐ Shelves black or white
- ☐ Stainless steel clips
- ☐ Flow track
- ☐ Gravity track
- ☐ Price tag molding
- ☐ Electronic lock models (swing doors only)
- ☐ 6" legs
- ☐ 3" or 6" Casters
- ☐ Door locks
- ☐ Custom signage & decals
- ☐ Remote option

**3 Year Parts/Labor Warranty**  
**Additional 2 Year Compressor Warranty**

### CABINET CONSTRUCTION

- Exterior finish is heavy duty steel with a white baked on durable coating
- Heavy duty interior construction includes white coated steel walls
- Modern one-piece grille
- Full electronic control
- Refrigerator have double pane lowE argon filled glass doors
- 120° stay open door feature, with automatic stay open feature
- Snap-in gaskets, easy to remove for cleaning or replacement
- Field reversible doors
- LED lighting, standard
- Fifteen (15) heavy duty epoxy coated wire shelves
- Four (4) shelf clips included per shelf
- Anti-microbial door handles
- Brightly lighted sign panel
- Self-contained bottom mount refrigeration system
- Maintains product temperatures between 36°-38°F

### REFRIGERATION SYSTEM

- Refrigeration system uses R290 refrigerant to comply with all environmental concerns
- Automatic, non-electric defrost
- Epoxy coated evaporator coil

MMR72HC Hinged Glass Door: Merchandiser Series



3779 Champion Blvd., Winston-Salem, NC 27105  
1-888-845-9800 Fax: 1-336-245-6453  
Beverage-Air.com sales@bevair.com



# BEVERAGE-AIR

MODEL	MMR72HC-1-W
<b>EXTERNAL DIMENSIONAL DATA</b>	
Width Overall	75"
Depth Overall with Handle	33 1/2"
Height Overall	78"
Number of Doors	3
Depth With Door Open 90°	55"
Door Opening (inches)	21 3/4" x 52 1/2"
<b>INTERNAL DIMENSIONAL DATA</b>	
NET Capacity (cubic ft.)	68.93
Internal Width Overall (in)	72"
Internal Depth Overall (in)	26"
Internal Height Overall (in)	61 5/8"
Internal Height Useable (in)	53"
Number of Shelves	15
<b>ELECTRICAL DATA</b>	
Full Load Amperes 115/60/1	6.2
<b>REFRIGERATION DATA</b>	
Horsepower	1/2
Capacity (BTU/Hr)*	2808
<b>WEIGHT DATA</b>	
Gross Weight (Crated lbs)	750 lbs
Height - Crated	85"
Width - Crated	77"
Depth - Crated	36"

## MMR Refrigerator Triple Glass Door Models: MMR72HC-1-W

### Model Views

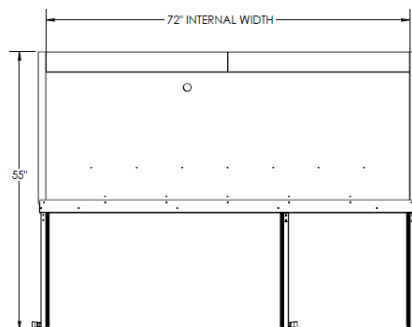

### Plan View

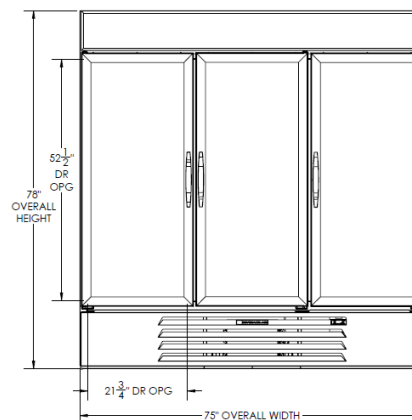

### Elevation View

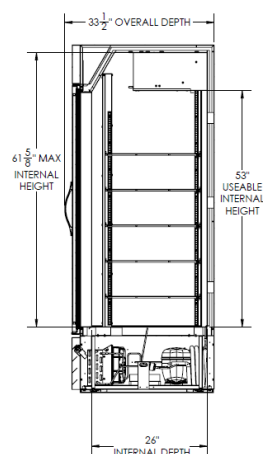

### Side View

### ELECTRICAL CONNECTION



115/60/1  
NEMA-5-15P

Units pre-wired at  
factory and include 8'  
long cord and plug set.



an Ali Group Company



The Spirit of Excellence

3779 Champion Blvd., Winston-Salem, NC 27105  
1-888-845-9800 Fax: 1-336-245-6453  
Beverage-Air.com sales@bevair.com